

**1530nm DFB 2mw Coaxial Pigtail Laser Diode with SMF**  
**1530nm Fiber Coupled LD with Single Mode Fiber (SM Fiber)**

WSLP-1530-002m-9-DFB

Wavespectrum laser Group

www.wavespectrum-laser.com

PARAMETER	SYMBOL	VALUE	UNIT
LD Reverse Voltage	$V_r$	2.0	V
PD Operating Current	$I_{r(PD)}$	2.0	mA
PD Reverse Voltage	$V_{r(PD)}$	15	V
Operating Temperature	$T_{op}$	-10 ~ +85	°C
Storage Temperature	$T_{stg}$	-40 ~ +85	°C
Lead soldering temperature (10 sec.)	$T_{is}$	260	°C
<b>Features:</b> <ul style="list-style-type: none"> <li>● 1530nm</li> <li>● DFB Laser Diode</li> <li>● Built-in Photodiodes</li> <li>● 9um SM Fiber</li> <li>● Isolator Optional</li> <li>● Coaxial or Receptacle Package Optional</li> </ul>			
<b>Applications:</b> <ul style="list-style-type: none"> <li>● Test Equipments</li> <li>● Optical Transmitter of Analog Signal</li> <li>● Optical Transmitter of Data Signal</li> </ul>			
<b>Specifications</b>		<b>WSLP-1530-002m-9-DFB</b>	
		Min	Type
Center Wavelength@25°C		+/-2nm	1530nm
			Max
Center Wavelength@25°C			+/-3nm
Laser Type		DFB	
Output Power		----	2mW
			----
Fiber Core		9um SM Fiber	
Threshold Current (Typ.) $I_{th}$		5mA	11mA
			15mA
Operating Current		----	30mA
			35mA
Forward Voltage		----	1.1V
			1.6V
Monitor Current		0.1mA	----
			----
PD Capacitance		----	10pF
			15pF
PD Dark Current		----	0.1uA
			0.1uA
Side Mode Suppression Ration		30dB	35dB
			----
Package Style		Coaxial ( Receptacle Optional)	
Data Rate		1.25Gb/s	
Isolator		Optional	
Connector Pin		A-type (B-type Optional)	
Fiber Connector		FC	



### Coaxial Package View

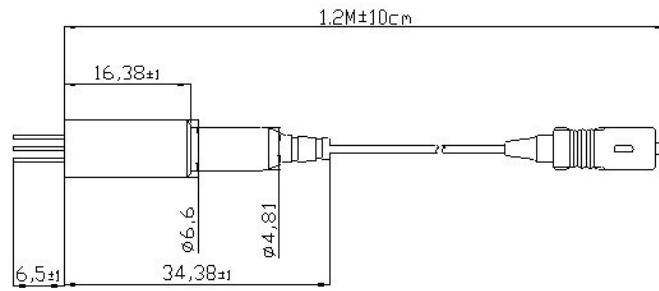

### Bottom View

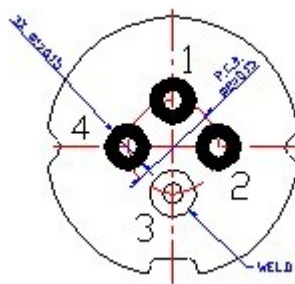

TYPE A  
PIN ASSIGNMENT:

1	PD Cathode
2	PD Anode
3	LD Anode, GND
4	LD Cathode

Electrically shorten LD module and store in non-extreme conditions.  
Suggest using the constant current power supply.

